

EVEREST[™]*nano* 1 μ m Pulsed Fiber Laser AP-1030

Applications:

- Laser marking/cutting/ablating
- General materials processing
- LIDAR
- Frequency Conversion

Features:

- All fiber design
- High pulse energy and peak power
- High repetition rate capability
- Near diffraction limited beam quality
- Rugged OEM package and compact size



Optical Characteristics:

Parameter	Specification
Operation mode	Pulsed
Operating wavelength	1030 nm
Average power	100 W (at 300 kHz)
Pulse repetition rate	50 kHz to 500 kHz
Pulse width	5 ns
Polarization	Random
Beam quality, M ²	< 1.3
Output power stability	Within $\pm 5\%$
Output delivery	Collimated output beam

(For custom requirements, please contact AdValue Photonics.)

Specifications subject to change without notice

General Characteristics:

Parameter	Specification
Operating temperature	10 to +30 °C
Storage temperature	+5 to +70 °C
Cooling	Water cooled (portable recirculating chiller available as an option)
Power requirement	AC 100~240 V (50/60Hz) (operating with AdValue Photonics Control Unit)
Warm-up time	10 minutes
Package dimensions	345(W) x 490(D) x 127(H) mm

Mechanical Outline:

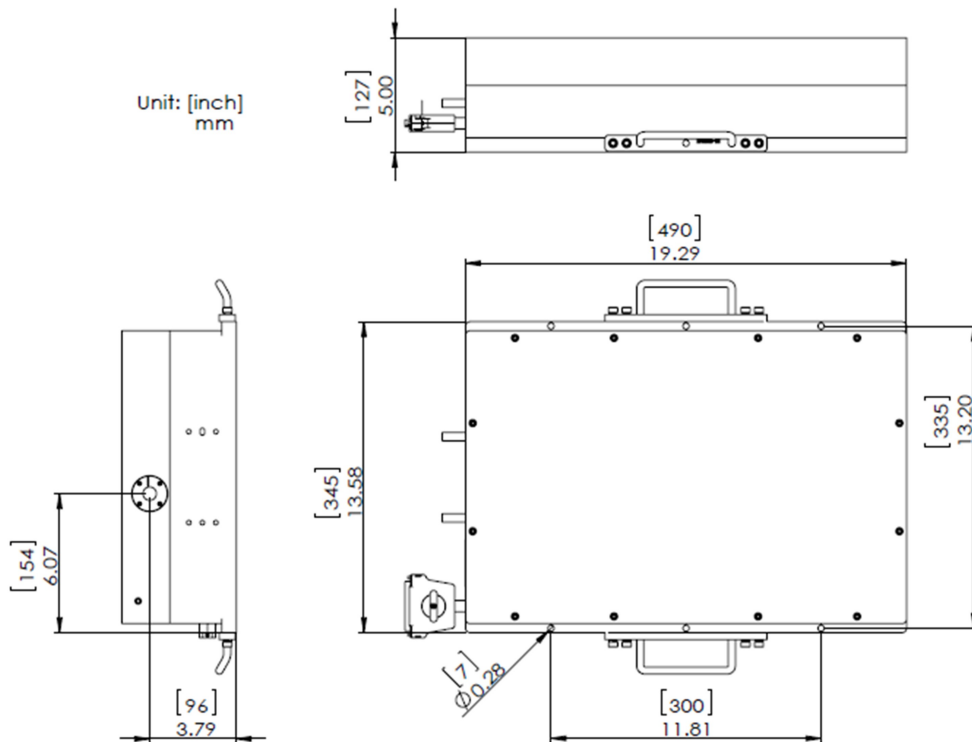

Ordering Information:

Part Number: AP - 1030 - 50 - 050 - 5N

Standard Wavelength:
1030 = 1030 nm

Output Power:
50 = 50 W
xx = xx W

Pulse Energy:
050 = 50 μJ
xxx = xxx μJ

Pulse Width:
5N = 5 ns

Specifications subject to change without notice